

DETAIL 2
SCALE 1:10

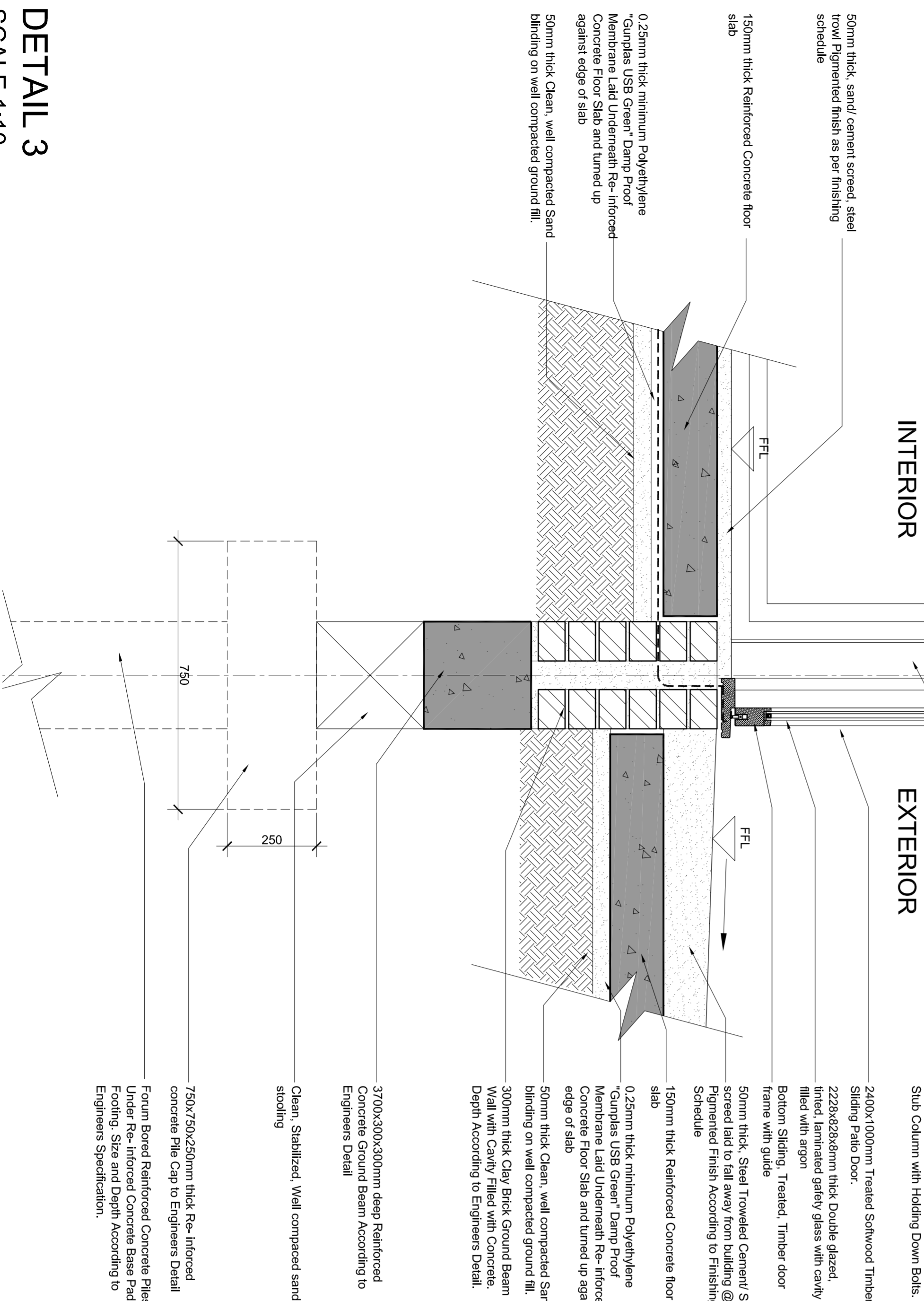

DETAIL 3
SCALE 1:10

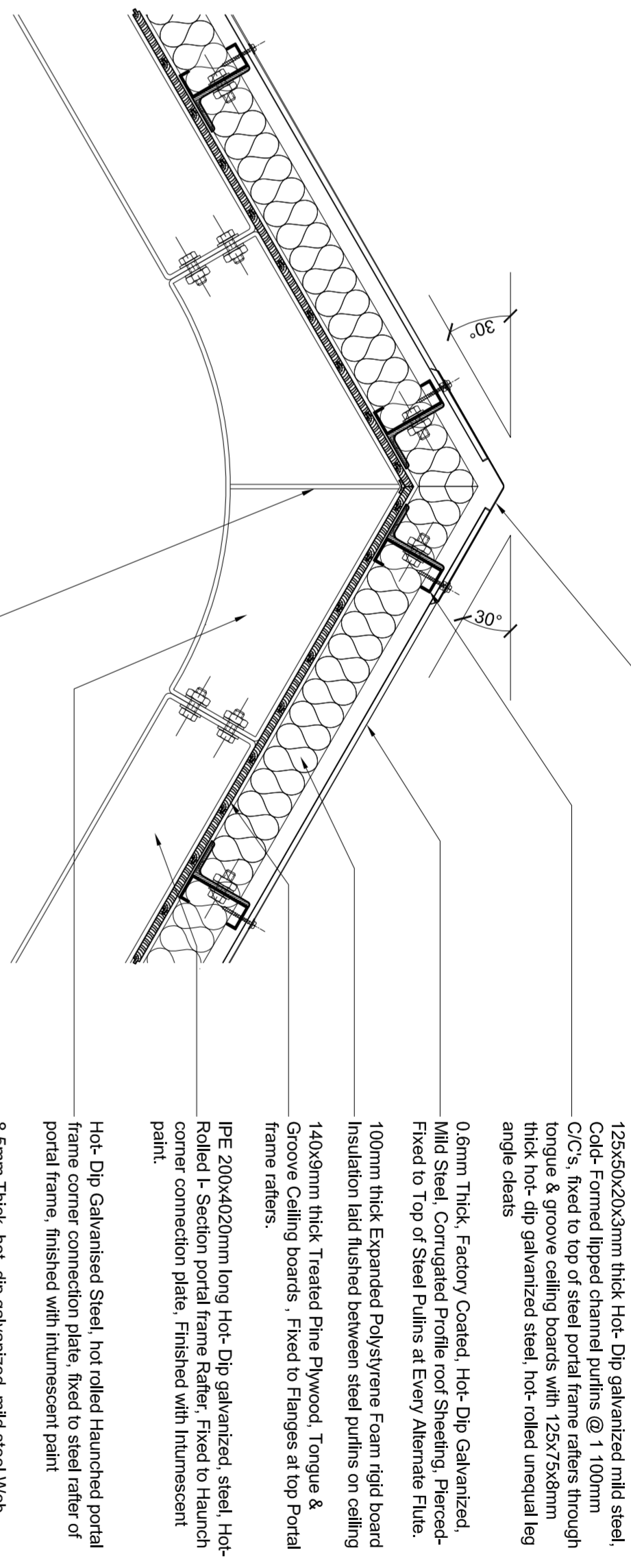

DETAIL 1
SCALE 1:10

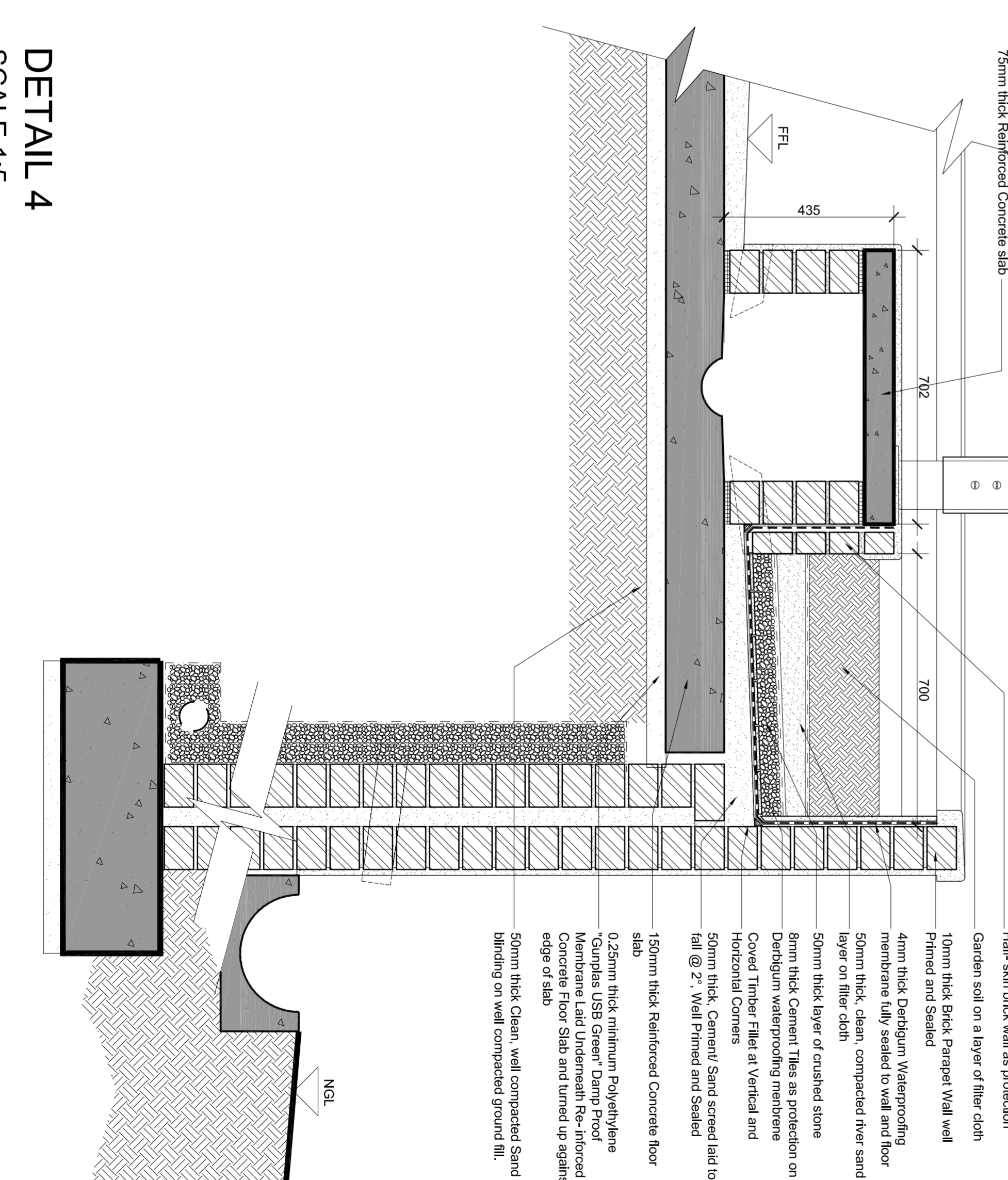

DETAIL 4
SCALE 1:5

KEY PLAN

The drawings must be read in conjunction with the Bills of Materials for a Full Description of the Extent of the Work to be Done. The Contractor Must Report any Discrepancy Between the Existing Building, The Specified Bills of Quantities and the Drawings, to the Architect or Project Leader, Before the Work Commences. The Contractor Must Report any Discrepancy Between the Specified Bills of Quantities and the Drawings, to the Architect or Project Leader, Before the Work Commences. The Contractor Must Report any Discrepancy Between the Specified Bills of Quantities and the Drawings, to the Architect or Project Leader, Before the Work Commences.

GENERAL NOTES

It is acceptable that the Contractor is an Expert in the Building Profession and that the Quantity of the Workmanship will be of the highest Standard as far as the Contractor is concerned. The Contractor Must Ensure the Safety, Health and Welfare of all Workers and other Persons on Site, at all Times, and Comply with the Safety Requirements of the Department of Labour. It is acceptable that the Contractor Familiarize Himself with the Conditions on Site Before Having Quoted for the Work. The Contractor Must Familiarize Himself with the Scope of the Work and Verify all Dimensions on Site Before the Work Commences. The Drawings Must be Scaled. Final Dimensions to be Used at all Times. Professional Land Surveyor to locate and Identify Existing Structures on Site and to Protect these from Damage Throughout the Duration of the Works. Contractor to Build all D.P.C.'s Whether or Not these are Shown on Drawings to all External Walls at Each Floor, and to all Windows, Doors or other Openings in External Walls. Contractor to Check the Details Shown on this Drawing Before Commencing Work with Standards of Good Building Practice with particular Reference to Special Conditions and Report any Comment to the Author. Any Error, Discrepancy or Omission to be Reported to the Author Immediately. Final Dimensions to be Taken on Site Before Ordering, Supplying and Fixing Proprietary or Detailed Filings. Contractors are to locate and Identify Existing Structures on Site and to Protect these from Damage Throughout the Duration of the Works. Contractor to Build all D.P.C.'s Whether or Not these are Shown on Drawings to all External Walls at Each Floor, and to all Windows, Doors or other Openings in External Walls. Contractor to Check the Details Shown on this Drawing Before Commencing Work with Standards of Good Building Practice with particular Reference to Special Conditions and Report any Comment to the Author. Any Error, Discrepancy or Omission to be Reported to the Author Immediately. Final Dimensions to be Taken on Site Before Ordering, Supplying and Fixing Proprietary or Detailed Filings. Contractors are to locate and Identify Existing Structures on Site and to Protect these from Damage Throughout the Duration of the Works.

REV.	DESCRIPTION:	DATE:	BY:

PROJECT STUDENT:	NAME OF CLIENT:
Student No: 298072982	Stude Work III
SIGNATURE OF STUDENT:	SIGNATURE OF CLIENT:

Cape Peninsula University of Technology

19 Jan Status Sheet
P.O. Box 652
CAPE TOWN 8000
TEL: (021) 440 2200
FAX: (021) 440 2500

NEW WINE TASTING & DELI RESTAURANT
Altygedacht Wine Farm, Durbanville
ERF 276- 11

WORKING DRAWINGS

STRUCTURAL DETAILS

DATE: 1 NOVEMBER 2010
SCALE & FORMAT: 1:10 @ A1
DRAWING BY: Gabriella Marini
DRAWING NO: 10-A10-07
PROJECT NO: A1/0-11/10

DRAWING PATH: C:\Users\Gaby\Desktop\Gaby layout template 2-Layout1.dwf